



## G160-3" ROOTS® Meter

	<b>UNITS</b>	<b>Metric/DIN</b>	<b>UNITS</b>	<b>Metric/ANSI</b>
Temperature Range	deg. C	-40 to +70	deg. C	-40 to +70
Base Rating (Q Max.)	m <sup>3</sup> /h	250	m <sup>3</sup> /h	250
Max. Operating Pressure (MAOP)	bar	12	bar	12
Leak Test (125% MAOP)	bar	15	bar	15
Static Test (2 x MAOP)	bar	24	bar	24
Rangeability +/- 1%	ratio	70:1	ratio	70:1
Rangeability +/- 2%	ratio	145:1	ratio	145:1
Start Rate	m <sup>3</sup> /h	0,1510	m <sup>3</sup> /h	0,1510
Stop Rate	m <sup>3</sup> /h	0,0960	m <sup>3</sup> /h	0,0960
Flow Rate @ 1,25 mbar, Gas	m <sup>3</sup> /h	112,6	m <sup>3</sup> /h	112,6
Avg. Differential, @ 100% Flow	mbar	2,8	mbar	2,8
Max. Pressurization Rate	kPa/sec	35	kPa/sec	35
Max. Operating Speed	rpm	1500	rpm	1500
Gear Ratio	ratio	360:1	ratio	360:1
Displaced Volume/Revolution	m <sup>3</sup>	0,002777	m <sup>3</sup>	0,002777
Drive Rate	m <sup>3</sup> /rev	1,0	m <sup>3</sup> /rev	1,0
Min. Odometer Reading	m <sup>3</sup>	0,020	m <sup>3</sup>	0,020
Odometer Turnover	yrs.	4,57	yrs.	4,57
Nominal Pipe Size	mm	80	mm	80
Flange-to-Flange	mm	241,3	mm	241,3
Flange Connection	DIN	DN80	ANSI	150#FF
Bolts per Flange	qty.	8	qty.	4
Bolt Size <sup>1</sup>	mm	M16	in.	5/8 - 11
Flange Bolt Hole Depth	mm	27	mm	27
Bolt Torque: Lubricated/Non-Lub.	N-m	74/81	N-m	74/81
Restricting Orifice (120%)	mm	20,638	mm	20,638
Oil Capacity – Side Inlet	ml	101	ml	101
Oil Capacity – Top Inlet	ml	645	ml	645
Net Weight	kg	29	kg	29
Shipping Weight	kg	34	kg	34
Carton Size	cm	84 x 32 x 28	cm	84 x 32 x 28

**NOTES:**

<sup>1</sup> Bolt Length varies by application.

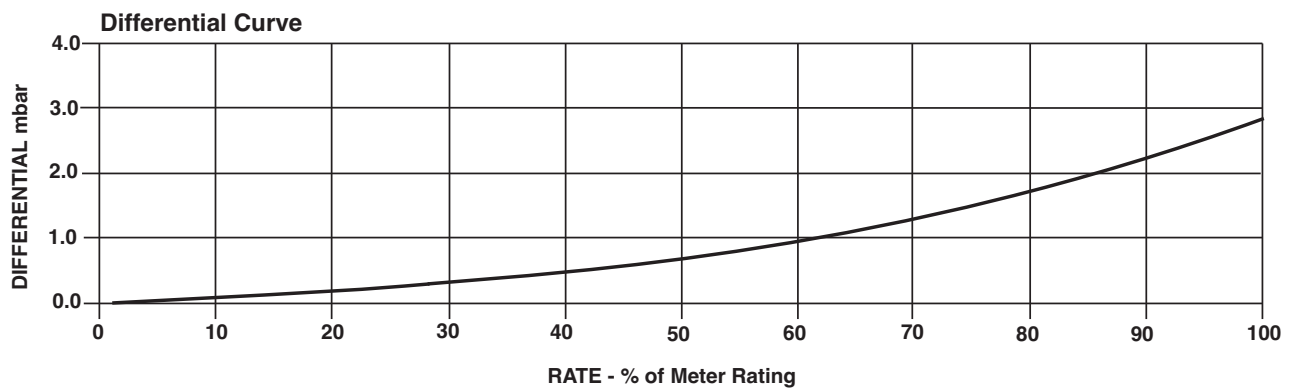
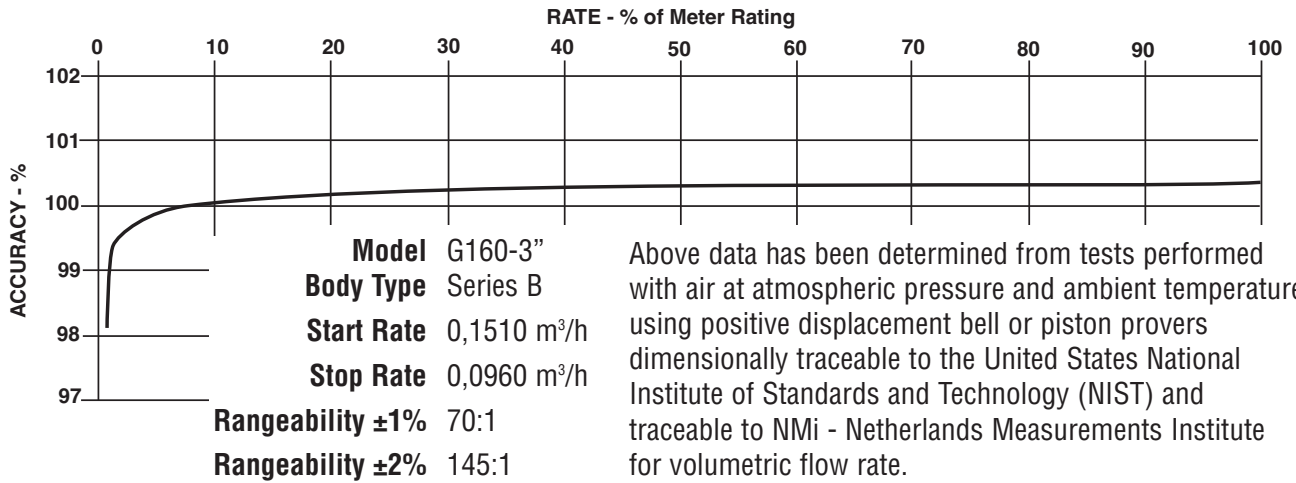

G160	Overall Length		Overall Height		Width (Flange/Flange)		Centerline to Accessory End (CL-AU)		Request Detailed Drawing Number
	inches	mm	inches	mm	inches	mm	inches	mm	
	19-49/64	502	8-7/8	225	9-1/2	241	11-1/2	292	D055452-000

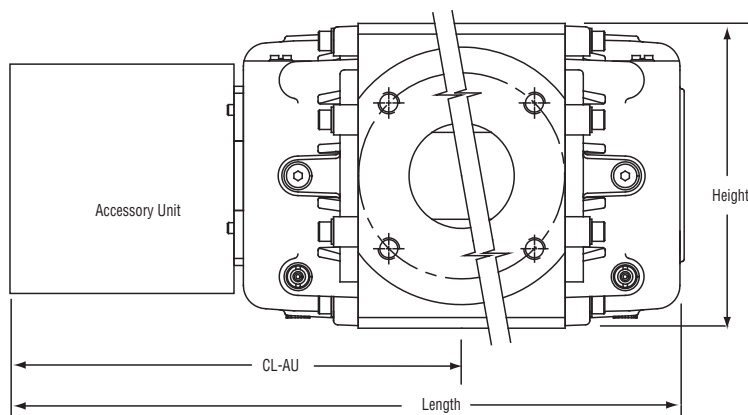

**Roots Meters & Instruments  
Dresser, Inc.**

16240 Port Northwest Drive  
Houston, Texas 77041-2645 USA  
Inside US Ph: 800.521.1114  
Outside US Ph: 832.590.2303

Fax: 800.335.5224  
Fax: 832.590.2494



[www.dresser.com](http://www.dresser.com)